

## External Wall Insulation Thin Coat System - NSC2 - High Rise Applications

### External Wall Insulation



**Diagram 2**

Thin Coat System - NSC2 - sequence of layers for high rise applications

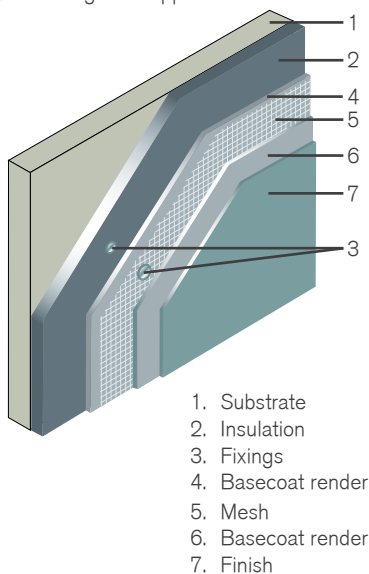

### Characteristics

The system uses a thin build up of high polymer modified render, with glass fibre mesh embedded within to create a finish ready to receive a high performance silicone decorative finish.

### Benefits

- Fast installation
- High thermal efficiency
- Excellent level of impact resistance
- Vapour permeable
- Flexible choice of final texture, colour and effect

### Insulants

Insulants available are:

- Mineral Wool
- Phenolic

Both insulants are available as rigid boards in standard sizes of 1200 x 600mm and in a range of thicknesses typically in increments of 10mm.

### First Fixings

First insulation board is located in position with one central fixing. The procedure is repeated for each board, butt jointing as the work proceeds.

### Basecoat Render - First Layer

First layer of high polymer modified basecoat render incorporating lightweight aggregates and reinforcing polyester fibres applied to a thickness of 2-3mm.

### Mesh

Glass fibre reinforcing mesh in roll form, embedded into first layer of basecoat render.

### Second Fixings

Further fixings are then installed through the mesh, basecoat and insulation boards nominally at the rate of 6-8 per m<sup>2</sup> including one fire rated fixing. Fixing type is dependant on existing substrate.

### Basecoat Render - Second Layer

In addition to the initial 2-3mm skim coat, a second layer of basecoat render is applied over the mesh to a final thickness of 4-6mm.

### Accessories

A wide range of bellcast, capping, bead and joint profiles are available in aluminium, polyester powder coated galvanised steel, stainless steel and PVCu to suit requirements.

### Finishes

- Silicone

### Areas Of Application

*Struchterm NSC2 High Rise system is suitable for any of the following provided that the substrate is structurally sound:*

1. Refurbishment of high rise social housing
2. Refurbishment of high rise commercial buildings
3. New build projects
4. Buildings over 18m high



**Agrément Certificate**  
**96/3243**  
**Product Sheet 3**

## Finishes

To complete the NSC2 high rise system a silicone finish is applied:



For more details, please see our **Renders & Finishes Datasheets.**



**Social Housing Refurbishment Project:**  
Thin Coat EWI System with Silicone finish



**Social Housing Refurbishment Project:**  
Thin Coat EWI System with Silicone finish

## Basecoat Render Application Procedures

The notes below are intended to give general guidance on the application of a basecoat render.

1. To prevent the appearance of efflorescence, do not render in cold, damp weather. Do not allow downpipes, sills and scaffolding to throw water onto setting render. Protect render from rain for at least 48 hours after application.
2. Where possible, application on individual wall surfaces should be completed in one operation. Where this is not practical, the location of day work joints should be agreed with the architect.
3. The basecoat, should be applied with a hawk and trowel using the normal method.
4. A darby float or straight edge must be used to ensure that the finishing coat (or coats) is applied to a uniformly levelled surface.
5. Allow 24 hours curing time before application of finishing coats.
6. Work must NOT be carried out in temperatures less than 5°C or more than 35°C.
7. During hot weather, it is recommended that work is started on the shady side of the building and continued round following the sun.
8. Drying conditions will vary according to wind, temperature and humidity.
9. Always protect window frames, quoins, etc.

**For further advice call our technical department on 01484 850098.**



**Social Housing Refurbishment Project:**  
Thin Coat EWI System with Silicone finish



**Social Housing Refurbishment Project:**  
Thin Coat EWI System with Silicone finish

**Struchterm Ltd is part of the Hanson-HeidelbergCement Group**

Struchterm Ltd, Bent Ley Road, Meltham, Holmfirth, West Yorkshire, HD9 4AP  
t: 01484 850098 f: 01484 851388 e: info@struchterm.co.uk www.struchterm.co.uk

